

Artist Impression Prepared by Webber Architects

SACRED HEART CENTRAL SCHOOL

LANDSCAPE PLAN

Prepared for Catholic Education - Archdiocese of Canberra & Goulburn
January 2026

STUDIO 26
URBAN DESIGN

m: 0413 782 764
e: hello@studio26urbandesign.com
w: www.studio26urbandesign.com

ACKNOWLEDGMENT OF COUNTRY

Studio 26 Urban Design acknowledge the Australian Aboriginal and Torres Strait Islander peoples of this nation. We acknowledge the Wiradjuri people as the Traditional Owners and Custodians of the land within the Cootamundra-Gundagai Regional Council Local Government Area that this project is located within.

We pay our respects to Aboriginal Elders, past and present. Studio 26 Urban Design are committed to honouring the Australian Aboriginal and Torres Strait Islander peoples unique cultural and spiritual relationships to the land, waters and seas and their rich contribution to society.

Image Sourced from Wiki Australia

Landscape Team

STUDIO 26
URBAN DESIGN

Document control

Sacred Heart Central School
7-31 Morris Street
Cootamundra
NSW 2590

Client



Acknowledgements

webber

Version	Date	Author	Issue
A	August 2025	EH	For Review
B	January 2026	EH	For Approval

CONTENTS

THE SITE

Introduction..... 5

THE PROJECT

Existing Site Features 7
Site Analysis 9
Landscape Plan..... 10
Elevation..... 11

LANDSCAPE ELEMENTS

Landscape Areas..... 13
Hardscape..... 14
Furniture..... 15
Planting Palettes..... 16



THE SITE



INTRODUCTION

LANDSCAPE INTENT

This Landscape Plan presents the key concepts and design vision for Sacred Heart Central School. The Concept Plan forms the foundation of this report and is supported by detailed drawings and sections illustrating the key components for the forthcoming Development Application.

A collection of character imagery has been included to communicate the intended design outcomes, showcasing ideas for landscape elements such as furniture, materials, and planting palettes.

Overall, the landscape design aims to deliver a robust and low-maintenance environment that enhances amenity, legibility, and environmental performance across the site. The intent is to support design principles that promote walkability, visual cohesion, and the creation of high-quality outdoor spaces for students, staff, and visitors of Sacred Heart Central School.

Design Philosophy

The design philosophy for Sacred Heart Central School has been developed through an understanding of the Landscape Concept Plan and the broader vision established by the Catholic Education - Archdiocese of Canberra & Goulburn. The key factors contributing to good landscape design include:

- Landscape Character and sense of place;
- Pedestrian Circulation Routes;
- Visual quality; and
- Green Links and planting.

These principles are expressed through site analysis, the selection of reference imagery, and proposed finishes and planting palettes that shape the Landscape Concept Plan for the development.

The concept responds sensitively to the existing landscape character and the vegetation of the surrounding school, ensuring the new works integrate seamlessly with their context.

EXISTING LANDSCAPE

The site, located at 7/13 Morris Street, Cootamundra, accommodates a well-established co-educational school serving students from Kindergarten to Year 10. The College operates under the governance of the Catholic Education Office of the Archdiocese of Canberra and Goulburn.

The site is relatively flat, with existing services located near the proposed building and adjacent classroom blocks. Several site constraints have been identified, including heritage considerations and access provisions for the proposed building and surrounding landscape treatments. The Masterplan that Webber Architects has developed responds to the site constraints and opportunities.

The Design

The Design The masterplan that has been developed by Webber Architects includes a 2 storey building containing the following uses at each level:

- Ground Level - Entry, Library Learning Hub, 2 x Seminar rooms, 4 x General Learning Areas, Staff spaces and Student Amenities
- Level 1 - Hub / Corridor, 2 x Science Labs, Prep room, Services, 4 x General Learning Areas, Staff spaces and Student Amenities

The landscape scheme establishes a cohesive public realm that connects the proposed building with the existing school campus. The design incorporates planting, generous pedestrian pathways, gathering and resting areas, and hardscape treatments that reinforce wayfinding, provide shade and visual amenity, and support CPTED (Crime Prevention Through Environmental Design) principles.

Planting areas associated with the new building will feature a layered shrub and grass understory to create a high-amenity frontage and clearly defined entries to both new and existing buildings.

Planting Palette

The planting palette responds to Cootamundra's temperate climate and features a selection of resilient, visually striking species that enhance the architectural character of the site. Feature trees are positioned along key pedestrian routes and entry points to provide shade and define circulation paths during the warmer months.

The proposed palette complements the existing street trees and respects the heritage character of the school's buildings and grounds. Understory planting will comprise a mix of native and introduced plant species, offering a variety of textures, colours, and flowering displays throughout the year.

Surface Finished

Surface finishes have been selected to meet the functional and aesthetic requirements of Sacred Heart Central School. Robust, high-quality, and low-maintenance materials will be specified to complement both the design intent and the school's heritage context.

Distinctive surface treatments will define key community and gathering spaces, providing a clear sense of arrival and enhancing the overall experience for students, staff, and visitors.

THE PROJECT

EXISTING LANDSCAPE FEATURES



Images supplied by Webber Architects

EXISTING LANDSCAPE FEATURES



View 5



View 6



View 7





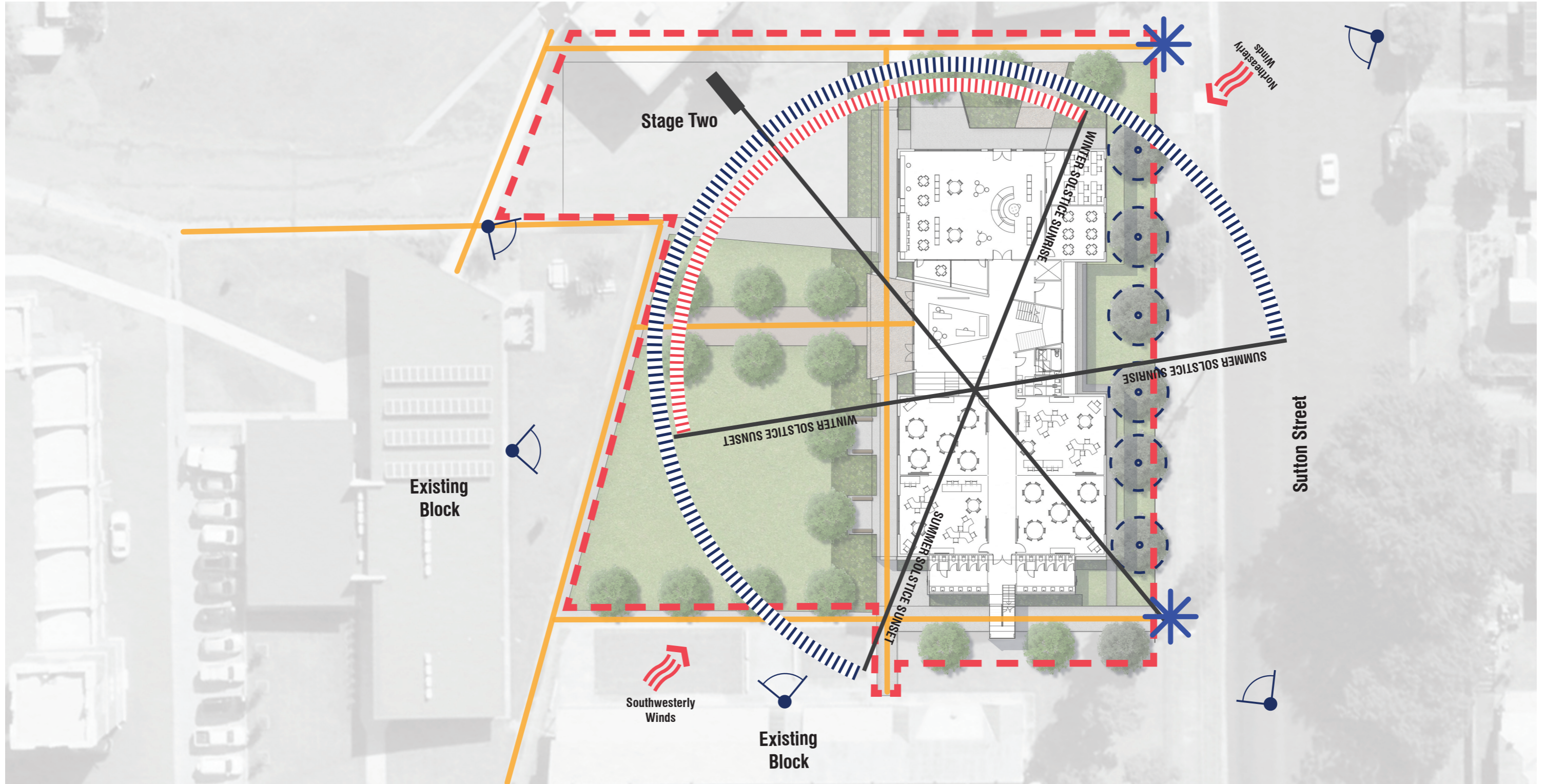

View 8

Images supplied by Webber Architects

SITE ANALYSIS



Key

-  Proposed Pedestrian Links
-  Key View Points towards the Proposed Building
-  Typical Wind Directions
-  Existing Tree to be Retained

 Pedestrian Entry From Sutton Street



LANDSCAPE PLAN

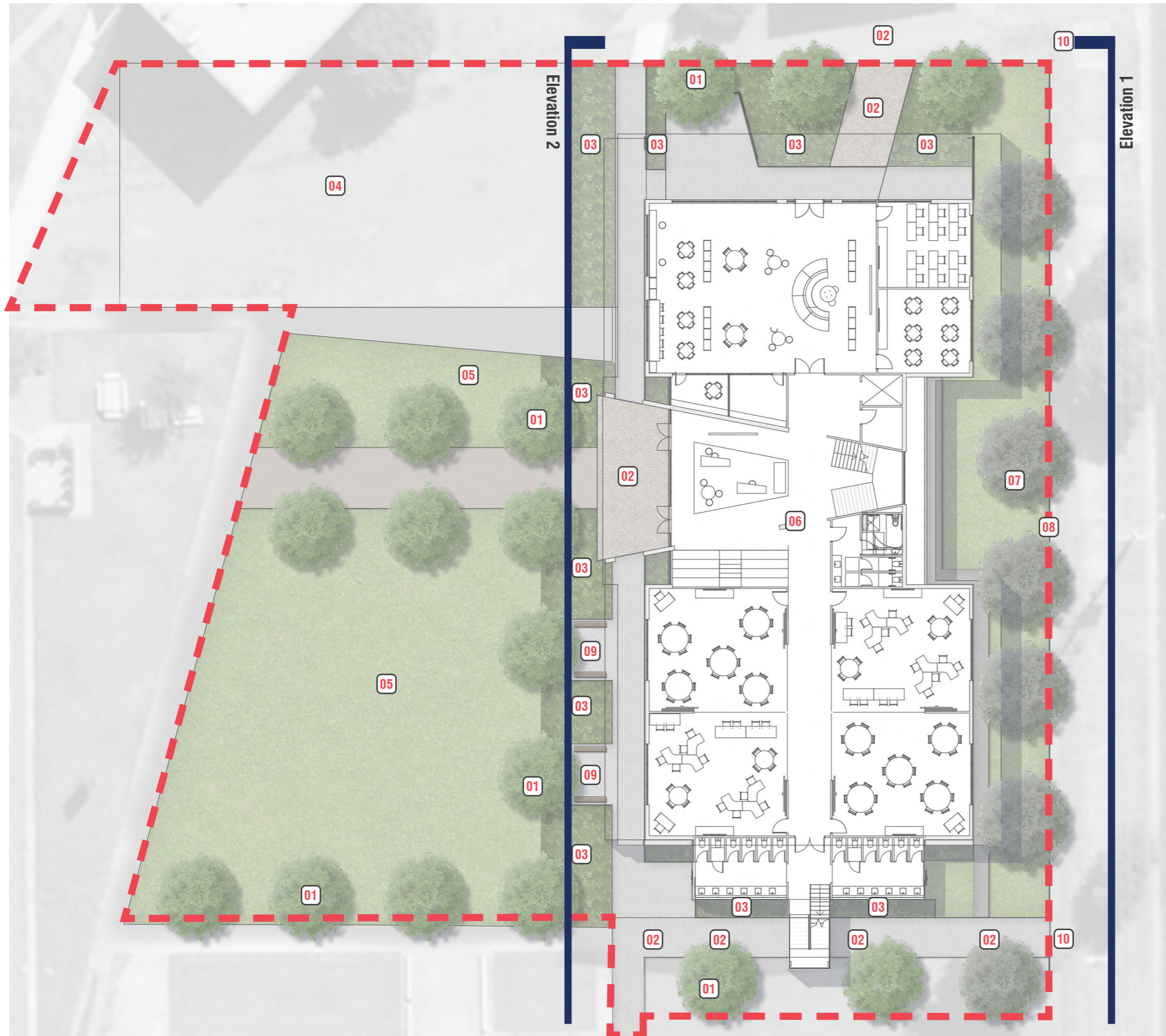

Key

- 01 Proposed Trees**
To be planted 1m from pathways
- 02 Proposed Pathways Network**
A minimum 1.5m wide pathway network connecting the proposed building to proposed and existing outdoor spaces and buildings
- 03 Proposed Planting**
Refer to Planting Palette on Page 16 for proposed species
- 04 Outdoor Seating Area**
This area to have a seating opportunities for Students and Staff to use
- 05 Open Lawn Area**
- 06 Proposed Building**
Refer to Webber Architects Drawings.
- 07 Existing Trees**
To be retained
- 08 Existing Boundary Fence**
To be retained
- 09 Outdoor Seating Area**
This area to have a seating opportunities for Students and Staff to use
- 10 Existing Entry Gate From Sutton Road**
To be retained

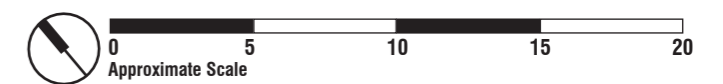

LANDSCAPE ELEVATION

N

S

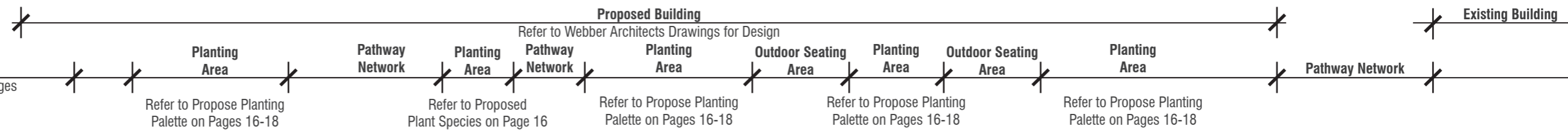

Elevation 1 - Sutton Street
Scale: NTS@A3

S

N

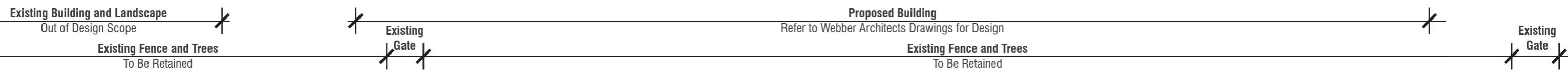

Elevation 2 - Sutton Street
Scale: NTS@A3

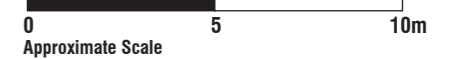

LANDSCAPE ELEMENTS

LANDSCAPE AREAS



HARDSCAPE AREAS



CCS - Apollo



Exposed Aggregate Concrete

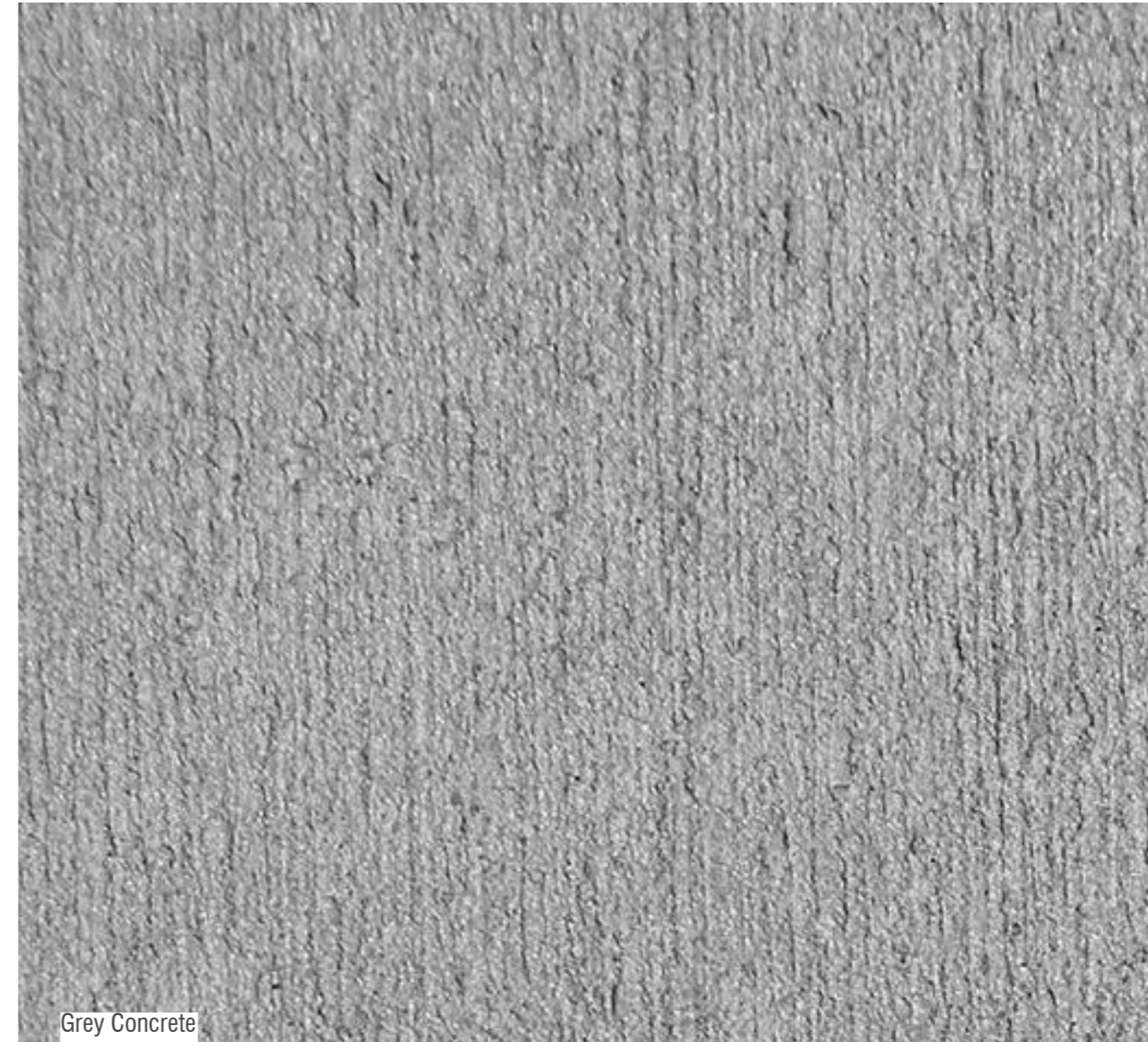

Grey Concrete

FURNITURE

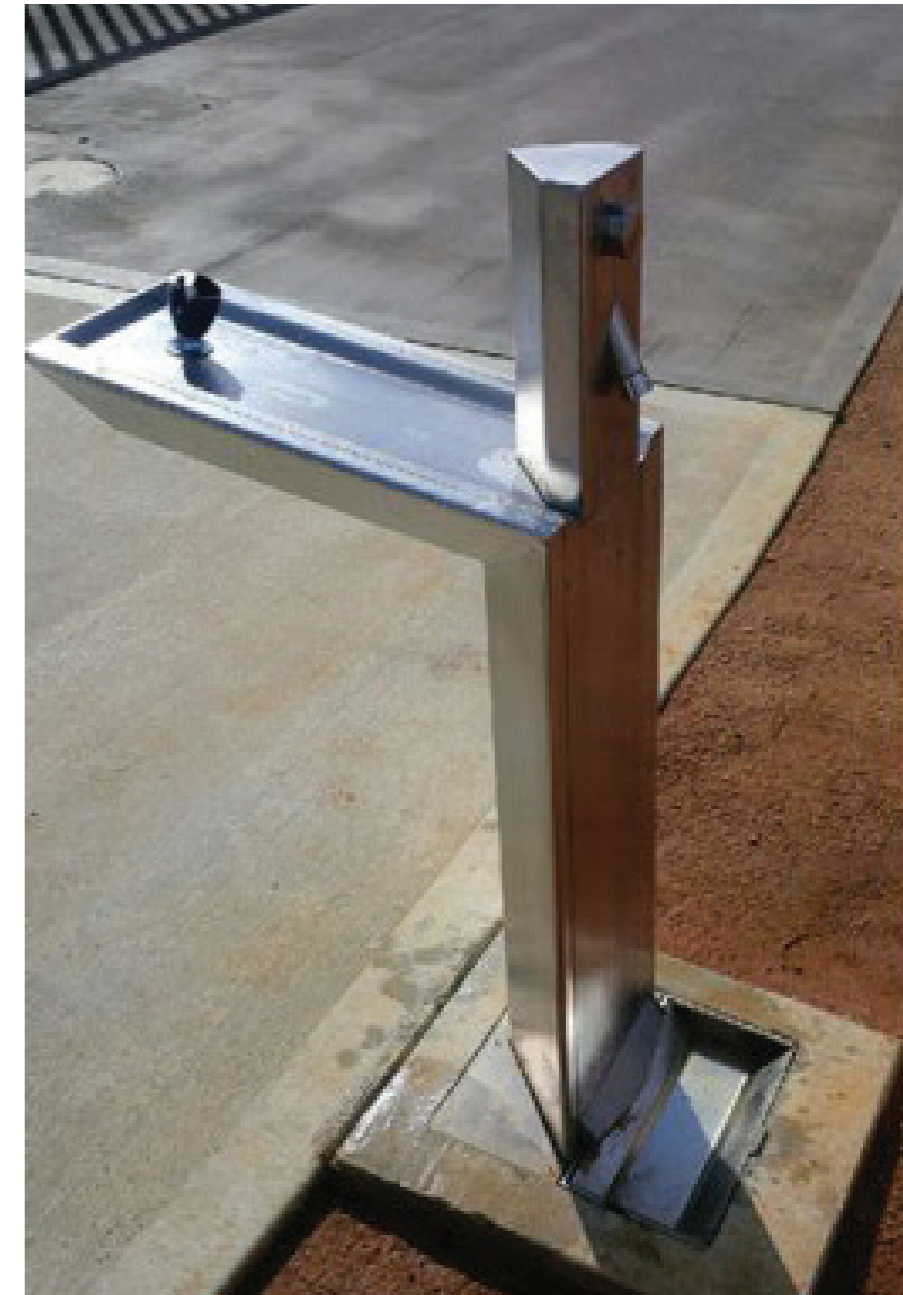

PLANTING PALETTE

Plant species

Botanical Name	Common name	H and W	Pot Size	Density m2
Trees				
<i>Acmena smithii</i>	Lilly Pilly	5x3m	45L	As Shown
<i>Acacia baileyana</i>	Cootamundra Wattle	8x5m	45L	As Shown
<i>Agonus flexuosa</i>	Willow Myrtle	15x10m	45L	As Shown
<i>Corymbia ficifolia 'Summer Red'</i>	Eucalyptus Summer Red	8x5m	45L	As Shown
<i>Corymbia ficifolia Dwarf</i>	Dwarf Flowering Gum	Up to 6m	45L	As Shown
<i>Corymbium citriodora</i>	Yellow Bloodwood	8x6m	45L	As Shown
<i>Cupaniopsis anacardioides</i>	Tuckeroo	12x4m	45L	As Shown
<i>Tristaniopsis laurina 'Luscious'</i>	Watergum	12x5m	45L	As Shown
<i>Waterhousia Floribunda</i>	Weeping Lily Pilly	8 x 5m	45L	As Shown
Shrubs and Ground Covers				
<i>Atriplex nummularia</i>	Old Man Saltbush	3x5m	140mm	As Shown
<i>Brachyscome multifida</i>	Cut-Leafed Daisy	0.5x1m	140mm	2
<i>Casuarina glauca 'Cousin It'</i>	Casuarina 'Cousin It'	0.5x2m	140mm	As Shown
<i>Callistemon salignus cvs.</i>	Callistemon	1x3m	140mm	As Shown
<i>Callistemon viminalis 'Better John'</i>	Callistemon	1.2x0.9m	140mm	As Shown
<i>Westringia fruticosa 'Low Horizon'</i>	Coastal Westringia	0.3x0.7m	140mm	2
<i>Convolvulus cneorum</i>	Silverbush	0.6x0.5m	140mm	5
<i>Chrysocephalum apiculatum</i>	Yellow Buttons	0.5x1m	140mm	As Shown
<i>Dichondra repens</i>	Kidney Weed	0.3x5m	140mm	As Shown
<i>Grevillea sp</i>	Grevillea	3-5x2-4m	140mm	As Shown
<i>Goodenia ovata</i>	Hop Goodenia	0.3x2m	140mm	As Shown
<i>Myoporum parvifolium</i>	Creeping Boobialla Yareena	0.15x0.3m	140mm	8
<i>Vinca minor</i>	Creeping Myrtle	0.15x0.6m	140mm	4
<i>Viola hederacea</i>	Ivy-Leaved Violet	0.1x1m	140mm	As Shown
Grasses				
<i>Actinotus helianthi</i>	Flannel Flower	0.5x2m	140mm	As Shown
<i>Agapanthus orientalis Dwarf White</i>	Agapantha	0.4x0.4	140mm	6
<i>Anigozanthos 'Gold velvet'</i>	Kangaroo Paw	0.6-1x0.6-1m	140mm	2
<i>Anigozanthos 'Ruby velvet'</i>	Kangaroo Paw	0.4x0.3m	140mm	4
<i>Carex appressa</i>	Tall Sedge	1x0.8m	140mm	2
<i>Dianella caerulea</i>	Blue Flax Lily	0.5-1x0.5-2m	140mm	2
<i>Dianella caerulea 'Little Jess'</i>	Blue Flax Lily	0.4x0.4m	140mm	4
<i>Dianella revoluta</i>	Flax Lily	1x1m	140mm	As Shown
<i>Dietes grandiflora</i>	Dietes	1x1m	140mm	As Shown
<i>Erigeron karvinskianus</i>	Seaside Daisy	0.6x1m	140mm	As Shown
<i>Festuca glauca</i>	Blue Fescue	0.5x0.5m	140mm	4
<i>Lavandula angustifolia</i>	Lavender	0.9x0.9m	140mm	As Shown
<i>Lomandra 'Lime Tuff'</i>	Spiny Matt Rush	0.6x0.6m	140mm	4
<i>Lomandra Lime Divine</i>	Lime Devine	0.3x0.3m	140mm	6
<i>Lomandra longifolia</i>	Mat Rush	1.5x1m	140mm	1
<i>Liriope 'Amethyst'</i>	Lily Turf	0.4x0.4m	140mm	6
<i>Pennisetum alopecuroides</i>	Fountain Grass	0.9x0.9m	140mm	As Shown
<i>Pennisetum 'Nafray'</i>	Fountain Grass	0.6x0.6m	140mm	4
<i>Poa labillardieri cvs.</i>	Tussock Grass	1.2x0.5m	140mm	4
<i>Stachys byzantina</i>	Lamb's Ears	0.3x0.25m	140mm	8
<i>Poa labillardieri 'cvs'</i>	Tussock Grass	1x0.5m	140mm	4
<i>Themeda australis</i>	Kangaroo Grass	1.5x0.6m	140mm	4

Trees



Corymbium ficifolia Summer Red



Cupaniopsis anacardioides



Tristaniopsis laurina

Shrubs & Ground Covers Grasses



Casuarina glauca 'Cousin It'



Backhousia myrtifolia

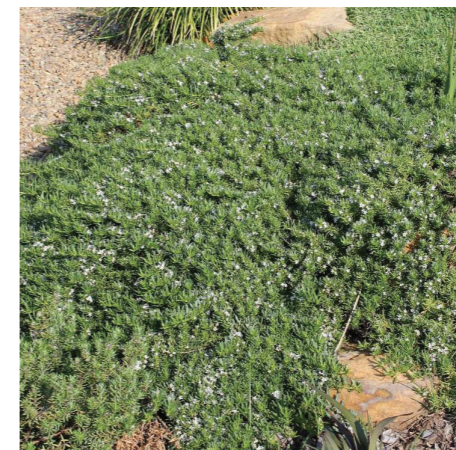

Myoporum parvifolium 'PARV01' PBR Yareena



Anigozanthos 'Gold velvet'



Festuca glauca



Pennisetum 'Nafray'

STUDIO 26
URBAN DESIGN

m: 0413 782 764
e: hello@studio26urbandesign.com
w: www.studio26urbandesign.com